



Convention on
Biological Diversity



Dear all participants

Regional Training Workshop on the SEEA Experimental Ecosystem Accounting in Asia Pacific (14-17 April 2015)

Welcome to Jakarta, Indonesia

BPS-Statistics Indonesia, as host, would like to inform you:

1. Transportation during workshop
 - There will be a bus to transport you from Hotel Borobudur to BPS, vice-versa, every morning.
 - An officer from BPS Protocol will be at hotel lobby every morning from 08.30am WIB (western-Indonesia time).
 - Please assemble at hotel lobby around 08.30-08.45am WIB. The bus will leave exactly 08.45am WIB.
 - The bus will take you back to Hotel Borobudur every day after the workshop at 05.00pm WIB.
2. For administrative purpose regarding distribution of DSA from UNDP, please bring your passport copied on 14 April 2015.

Thank you for your kind attention.

**Warm Regard,
BPS-Statistics Indonesia**



Jakarta - General Information

Indonesian currency is called Rupiah (IDR)

Exchange rate Currency: 1 USD (approximately) IDR 13,000.00

Climate: Jakarta has a tropical monsoon climate. Despite being located relatively close to the equator, the city has distinct wet and dry seasons. The wet season in Jakarta covers the majority of the year, running from October through May. The remaining four months constitute the city's dry season. Located in the western part of Java, Jakarta's wet season rainfall peak is January with average monthly rainfall of 389 millimetres (15.3 in).

Temperature:

- Average high °C (°F)	32.5 (90.5)
- Daily mean °C (°F)	27.9 (82.2)
- Average low °C (°F)	25.1 (77.2)
- Average rainfall mm (inches)	131 (5.16)
- Average relative humidity (%)	82

How to Get the Hotel from Soekarno Hatta Airport:

- (From the Hotel Service)
Airport Transfer by Silverbird: Rp. 440.000 net per car per way for maximum 3 people. Please advise if require. Kindly approach Golden Bird counter directly located after luggage claim.
- There is other option is taking regular taxi that can be hired at the airport. Make sure to get the taxi from the counter, rather than hail taxis from the kerb.
- There are buses going into town, name "Damri". Take the one goes to Gambir station. Bus ticket is Rp. 40.000 one way. Gambir station to Borobudur is only 800m. (10 minutes walk, take bajaj, or taxi)

Workshop Venue

Workshop will be held at the BPS (Statistic Indonesia office), which Located at Jalan dr. Sutomo no 6-8, Buliding 3 ground floor, except meeting on 15th April will be held in Building 2 floor 2.

Workshop participants are pleased to utilize a small clinic located on the ground floor building 5. Minimart also located in this building to provide snack, toiletries, etc. Next to minimart, canteen are available for BPS employee.

Dine Out Around Hotel

There are many street foods around hotel. However, affordable restaurants are available at Jalan Juanda, which is around 2-3 km from the hotel. Gambir station, as the biggest station in Jakarta, also has many restaurants for dining out. Nevertheless, if you want to go a bit further for Indonesian culinary both street food and restaurant, around Menteng Park will be the best. It is about 5-6 km from hotel Borobudur. Besides, restaurant there also Batik Keris shop, where you can buy fancy Indonesian craft. The other Malls close to the Hotel are Atrium mall and Golden truly, which are around 2-3 km from Hotel Borobudur. While, grand Indonesia is big exclusive mall that is passed by the city tour bus.

Get Around

- The most comfortable way to get around Jakarta is by renting a car or take a taxi. Best call for a taxi from hotel or mobile. There are "car calls" and valet services available at all hotels and malls to call drivers.
- For more adventurous try the TransJakarta express buses, which connect the main streets of Jakarta and are more reliable. Electronic payment card is required and available in every bus shelter.
- Jakarta also has free double decker City Tour bus. The operational hour for city tour bus is 9am - 7pm from Monday to Saturday, while for Sunday it's 12pm - 7pm due to the car free day on Sunday. There are 9 bus stops: Bundaran Hotel Indonesia (in front of Hotel Indonesia) - Museum Nasional - Pecenongan - Gedung Kesenian Jakarta - [Istiqlal Mosque](#) - Medan Merdeka Utara (near Istana Negara) - Monumen Nasional - City Hall - Sarinah - back to Bundaran Hotel Indonesia. The bus stop sign is marked "city tour". For weekdays, the bus will stop at all of the bus stops, while for weekends each bus will stop at several bus stops only.

To Do

The Thamrin-Sudirman avenues

To get to know Jakarta one has to travel its main streets. At the heart of Jakarta's Central Business District is the wide Sudirman-Thamrin Avenue, with tall high rise towers on either side. Separating the Sudirman from the Thamrin road is the large central fountain that become the city landmark with its statue of a boy and a girl welcoming you to Jakarta. This roundabout, known as Bundaran HI with Patung Selamat Datang (welcoming statue). Because of its strategic location, Bundaran HI is the preferred location for public demonstrations, exactly because of the continuous busy traffic circulating here.

Indonesia's top shopping centers are also located here. These are the exclusive Plaza Indonesia and the Grand Indonesia. Behind these are famously more affordable malls of Tanah Abang dan Thamrin City.

National Monument

The Sudirman-Thamrin avenue leads to the Merdeka Square, where in its center stands the National Monument (monas). The 137 meter tall National Monument is obelisk shaped, and is topped with a 14.5 meter bronze flame coated with 32 kilograms gold leaf. A lift takes visitors up to the look-out platform at the base of the flame for a grand view of Jakarta. It is open daily from 8.00-15.00 everyday except last Monday of the month. Surrounding the Monument is now a park with a musical fountain, enjoyed by the Jakarta public on Sundays for sports and recreation. Deer roam among the shady trees in the park.

Surrounding Merdeka Square is the location of most important government buildings influence by Dutch architecture. During Dutch colonial days here was the center of government, known as Koningsplein or the King's Square. The north side is dominated by the Merdeka Palace once the home of the Dutch Governor Generals, which now also houses the office of the President and the Cabinet. To the South is the office of Indonesia's Vice President, Jakarta's Governor and the provincial parliament building, as also the American Embassy, while to the West is the National Museum, the Constitutional Court, the Ministry for Culture and Tourism and the Indosat building, Indonesia's first international telecommunications company.

National Museum

Being two centuries old, National Museum of Indonesia (museum nasional) is an icon that must be visited. It is located at Jalan Medan Merdeka Barat in center of Jakarta city and it is an archeological, historical, ethnological, and geographical museum. Jakarta's national museum is well known as Elephant Building (gedung gajah) because of the elephant statue there.

Lapangan Banteng

Beyond Merdeka Square lie principal Dutch colonial buildings constructed in neoclassical style during the 19th century, that include buildings surrounding Lapangan Banteng, or Banteng Square, namely the present day Department of Finance, the neo-gothic Catholic Cathedral and adjoining Sancta Ursula girls' school, and further down the Foreign Office and the Imanuel protestant church, facing Jakarta's main Gambir station.

Across the road to the Cathedral stands now Jakarta's largest mosque, the Istiqlal mosque. Nearby is the Concert Hall and colonial style shopping street called Pasar Baru, once the preferred haunt of the wealthy Dutch elite. In the 18th century, Dutch Batavia was famed as the "Queen of the East".

National Gallery

National Gallery is a combination of museum and art gallery in Jakarta, where we can enjoy culture, history and visual arts.

Old Batavia

Behind the President's Palace is the canal which runs north pass the old Archive building to the Old Batavia, once the seat of the Dutch East Indies Company, VOC, built by Governor-General Jan Peterszoon Coen in the 17th century. Here renovations continue to preserve this historic area of the city which is dominated by the Stadhuis, or municipal building, which now houses the Jakarta History museum. In front of it is a central paved plaza, now named the Fatahillah Square, after Sultan Fatahillah, founder of this port, who, before the arrival of the Dutch razed the old harbour to the ground on 22 June 1527 and renamed it Jayakarta, City of Victory. The square is surrounded by once important Dutch government buildings that have now become museums, among which the Fine Arts Museum , the Wayang Museum, and the Museum Bank Mandiri.

Walk around Pasar Baru (Jakarta's market)

Come here for the nostalgic walk down the memory lane in Pasar Baru, where it is one of the rare streets of Jakarta that is actually pedestrian friendly. Start walking from Metro Atom at Jalan H. Samanhudi and then walk towards the rear end which is the Jakarta Art center (Gedung Kesenian Jakarta).

Gedung Kesenian Jakarta (Jakarta Arts Theater)

Built during the Dutch colonial period, Gedung Kesenian Jakarta is a concert hall in Jakarta, Indonesia. It is situated close to the Istiqlal Mosque and the Jakarta Cathedral. Check out the various arts program lined up, ranging from theater shows to musical performances.

Kuningan and Parliament Building

Other important areas in Central Jakarta are the Jalan Gatot Subroto, where stands Indonesia's Parliament building, and the Jalan Rasuna Said, location of most foreign Embassies.

BPS MAP

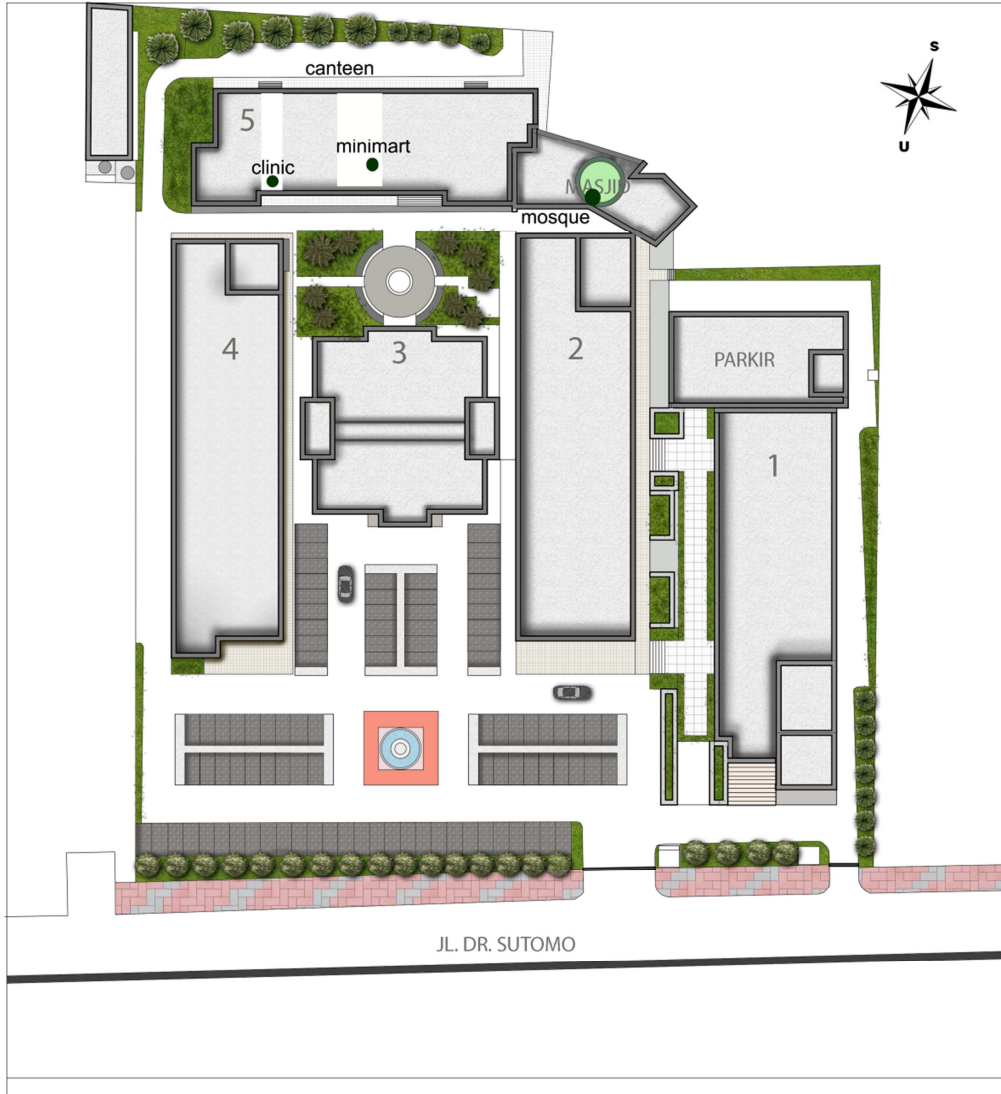

City Bus Tour Route:

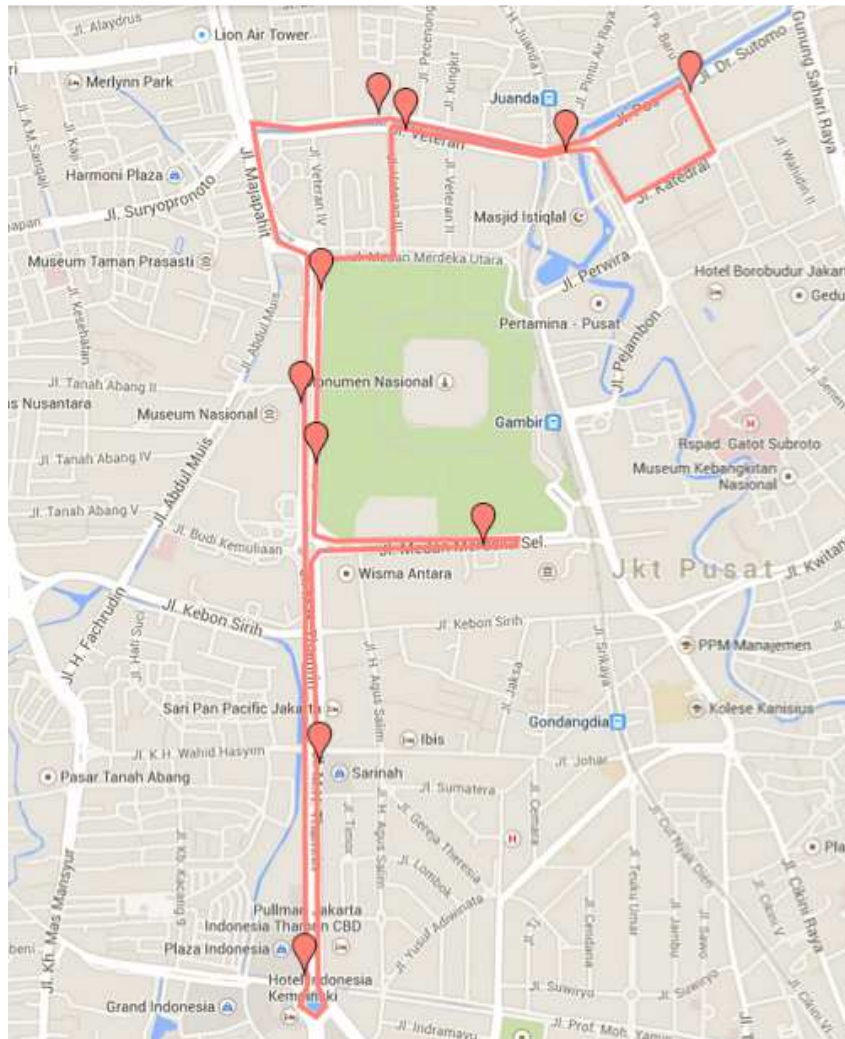

Rute City Tour - Jakarta (Double-decker bus)



Rute City Tour Jakarta

- Polygon 1
- Shelter Bundaran HI
- Shelter Museum Nasional
- Shelter ANZ Bank (Pecenongan)
- Shelter Gedung Kesenian Jakarta (...)
- Shelter Masjid Istiqlal
- Shelter Jl Veteran
- Shelter Monumen Nasional I
- Shelter Monumen Nasional II
- Shelter Balai Kota
- Shelter Sarinah

Resources:

<http://www.indonesia.travel/en/destination/474/jakarta>

<http://www.emp.pdx.edu/hliono/Jkt.html>

<http://allindonesiatravel.com/things-to-do-and-must-see-jakarta/>