

New York Resource Guide

United Nations Statistics Division

Ninth Meeting of the United Nations Committee of Experts on Environmental
Economic Accounting

25 - 27 June 2014

United Nations Secretariat Building (15th floor - Conference Room S-1522)



1. Meeting Information

Title

Ninth Meeting of the United Nations Committee of Experts on Environmental Economic Accounting

Dates

25-27 June 2014

Venue

United Nations Secretariat Building (15th floor - Conference Room S-1522)

Time

The sessions will be from 9:30 a.m. to 5:30 p.m. on 25 June, from 9 a.m. to 5:30 p.m. on 26 June and from 9:00 a.m. to 3:30 p.m. on 27 June.

Registration and Ground Passes

Registration of participants will be from 9.00 a.m. to 9.30 a.m. on the first day, 25 June. Participants should enter the UN complex via the temporary screening facility at 47th Street (see map in the following page). A grounds pass is required at all times to enter all United Nations buildings. A UNSD staff member will be stationed at the 47th Street entrance to provide you with your ground pass. After going through the screening facility please follow the path as shown in the map below to the conference building; once inside the conference building please follow the signs to the secretariat building where you can take the mid-rise or high-rise elevators to the 15th floor. It takes about 15 minutes to walk between the temporary screening facility and the meeting venue. Please bring all the necessary documentation if you are being funded by United Nations Statistics Division (UNSD).

If you have a UN ID (coordinated through your country's mission to the UN) you can also use the 42nd street entrance which is closer to the meeting venue. There is no need to go through the 47th street entrance to pick a ground pass.

Map of the United Nations Main Complex

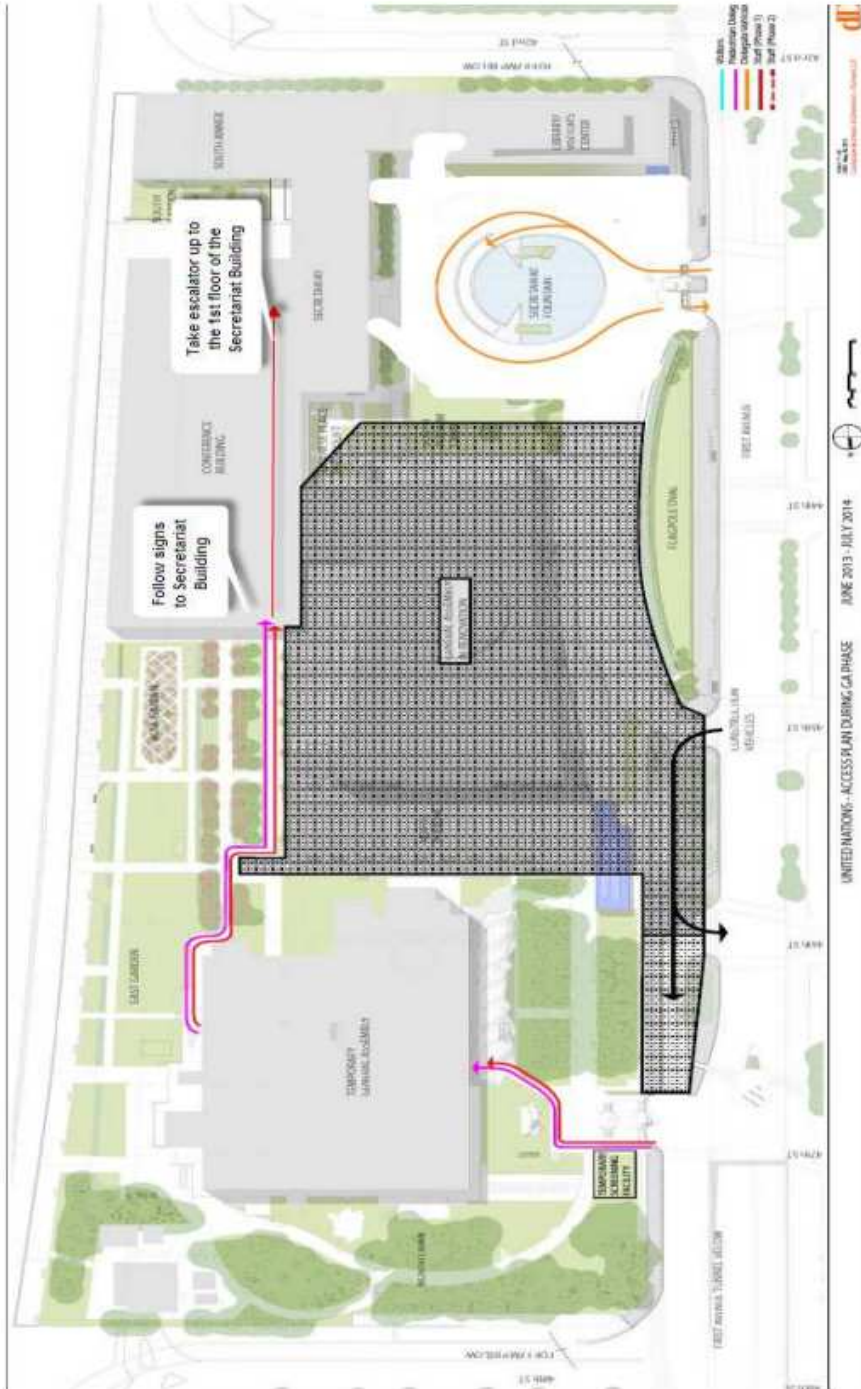

2. New York Information

Hotels and Other Accommodations

Arrangements for hotels need to be made by individual participants at hotels of their own choice. A list of hotels in the vicinity of the UN is provided below.

Please note that a credit card is normally required to make a reservation, participants should plan accordingly.

Below are some popular web sites for hotels:

www.expedia.com

www.hotels.com

www.orbitz.com

Hotels in the vicinity of the United Nations

Below is the list of hotels located in the vicinity of the United Nations (walking distance to the UN).

Hotel	Address	Telephone	Website
ALGONQUIN	59 W. 44th St.	(1-212) 840.6800	www.algonquinhotel.com
BEDFORD	118 E. 40th St.	(1-212) 697.8100	www.bedfordhotel.com
BEEKMAN	3 Mitchell Place (E. 48th and 1st Ave.)	(1-212) 355.7300	www.affinia.com
BENJAMIN	125 E. 50th St.	(1-212) 753.2700	www.thebenjamin.com
Hotel	Address	Telephone	Website
MILLENNIUM HOTEL	1 UN Plaza (E. 44th St at 1st Ave)	(1-212) 758.1234	www.millenniumhotels.com
CROWNE PLAZA AT THE UNITED NATIONS	304 E. 42nd St.	(1-212) 986.8800	www.ichotelsgroup.com
DIPLOMAT RESIDENCE	210 E. 47 th St.	(1-212) 371.6029	e-mail: Diplomat210@aol.com
EASTGATE TOWER	222 E. 39th St.	(1-212) 687.8000	www.affinia.com

DYLAN	52 E. 41st St.	(1-212) 338.0500	www.dylanhotel.com
ENVOY CLUB	377 E. 33rd St.	(1-212) 481.4600	http://www.envoyclub.com
FITZPATRICK	141 E. 44th St.	(1-212) 351.6872	www.fitzpatrickhotels.com
HELMSLEY PARK LANE	36 Central Park South	(1-212) 521.6239	www.helmsleyhotels.com
MARCEL	201 E. 24th St.	(1-212) 696.3800	www.themarcelatgramercy.com
MELROSE HOTEL	140 E. 63rd St.	(1-212) 838.5700	www.melrosehotelnewyork.com
METROPOLITAN	569 Lexington Ave.	(1-212) 752.7000	www.metropolitanhotelnyc.com
MIDDLETOWN HELMSLEY	148 E. 48th St.	(1-212) 755.3000	www.helmsleyhotels.com
BENTLEY	500 E. 62nd St.	(1-212) 644.6000	www.bentleyhotelnyc.com
NEW YORK HELMSLEY	212 E. 42nd St.	(1-212) 490.8900	www.helmsleyhotels.com
PICKWICK ARMS	230 E. 51 st St.	(1-212) 355.0300	www.pickwickarms.com
RADISSON	511 Lexington Ave.	(1-212) 755.4400	www.radisson.com
ROGER SMITH*	501 Lexington Ave.	(1-212) 755.1400	www.rogersmith.com
SAN CARLOS	150 E. 50 th St.	(1-212) 755.1800	www.sancarloshotel.com
WARWICK	65 W. 54 th St.	(1-212) 247.2700	www.warwickhotelny.com

Hotels which are a long walk or a non-walking distance from the UN

The hotels listed below are located further from the United Nations Complex (long walk or non-walking distance to the UN).

Hotel	Address	Telephone	Website
Affinia Dumont	150 East 34th Street (Lexington and Third Avenues)	(1-212) 481-7600	www.affinia.com
Belleclaire Hotel	250 W. 77 th Street	(1-212) 362-7700 Fax: (1-212) 362-1004	www.hotelbelleclaire.com e-mail: reservations@hotelbelleclaire.com
Carlton Arms Hotel	160. E. 25 th Street	(1-212) 679-0680	www.carltonarms.com e-mail: artbreakhotel@aol.com
Chelsea Hotel	222 West 23rd Street (7th and 8th Avenues)	(1-212) 243-3700	www.hotelchelsea.com
Doubletree Metropolitan	569 Lexington Avenue (51st Street)	(1-212) 752-7000	www.metropolitanhotelnyc.com
Excelsior Hotel	45 West 81st Street (Central Park West and Columbus Avenue)	(1-212) 362-9200	www.excelsiorhotelny.com
Gershwin Hotel	7 East 27th Street (Madison & 5th Avenues)	(1-212) 545-8000 Fax: (1-212) 684-5546	www.gershwinhotel.com e-mail: reservations@gershwinhotel.com
Hotel QT	125 West 45th Street (Avenue of the Americas and 7th Avenue)	(1-212) 354-2323	www.hotelqt.com
Hotel Riverview	113 Jane Street (between W. 12 & 14 th Streets)	(1-212) 929-0060 Fax: (1-212) 675-8581	www.hotelriverview.com e-mail: Hriverview@aol.com

Hotel	Address	Telephone	Website
Hotel Stanford	43 West 32nd Street (Broadway and 5th Avenue)	(1-800)-365-1114	www.hotelstanford.com
Hudson Hotel	356 West 58th Street (8th and 9th Avenues)	(1-212) 554-6000	www.hudsonhotel.com
The Macaw Guesthouses	106 E. 101 st Street	(1-212) 348-4643	www.themacawguesthouse.com
Off SoHo Suites Hotel	11 Rivington Street (Bowery and Chrystie Streets)	(1-800)-633-7646	www.offsoho.com
The Time	224 West 49th Street (Broadway and 8th Avenue)	(1-877)-846-3692	www.thetimeny.com

Hostels

Hostel	Address	Telephone	Website
Central Park Hostel	19 West 103 rd Street	(1-212) 678-0491 Fax: (1-212) 678-0453	www.centralparkhostel.com e-mail: info@centralparkhostel.com
Hostelling International	891 Amsterdam Avenue	(1-212) 932-2300 Fax: (1-12) 932-2574	www.hinewyork.org e-mail: reserve@hinewyork.org

Apartment/Residences/International Houses/YMCA

Name	Address	Telephone	Website
Chelsmore Apartments	205 W. 15 th Street (between 7 th & 8 th Avenues)	(1-212) 924-7991 Fax: (1-212) 727-7284	www.chelsmore.com e-mail: reservations@chelsmore.com
DeHirsch Residence Operated by 92 nd Street YMCA	1395 Lexington Ave (at 92 nd St)	(1-212) 415-5650 (1-800) 858-4692 Fax: (1-212) 415-5578	www.92ndsty.org e-mail: dehirsch@92ndsty.org
Harlem YMCA	180 W. 135 th St.	(1-212) 281-4100	e-mail: harlemguestrooms@ymcanyc.org
Vanderbilt YMCA	224 E. 47 th St (between 2 nd & 3 rd Avenues)	(1-212) 756-9600 Fax: (1-212) 752-0210	www.ymcanyc.org

Airports

There are 3 major airports serving New York City. They are:

1. **John F. Kennedy International Airport:** Phone: 1-718-244-4444. Located in Queens, New York, about 15 miles from Midtown Manhattan.
2. **Newark Liberty International Airport:** Phone: 1-973-961-6000. Located in Newark, New Jersey, about 16 miles from Midtown Manhattan.
3. **La Guardia Airport:** Phone: 1-718-533-3400. Located in Queens, New York about 8 miles from Midtown Manhattan.

Information regarding these 3 airports can be accessed online at:

www.panynj.gov./aviation.html

Airport Transportation

Complete transportation information for the above 3 airports can be obtained by calling **Air-Ride** ph: 1-800-AIR RIDE (toll free number within the U.S.). Please find below the options of transportation from the airports to Midtown Manhattan:

From JFK International Airport

Service	Fare	Estimated Time of Arrival	Frequency	Notes
<p><u>AirTrain JFK</u></p> <p>(www.panynj.gov/airtrain) Connection with NYC subway (www.mta.info/nyc/subway) Connection with Long Island Railroad (LIRR) direct to Penn Station (www.mta.info/lirr)</p>	<p>\$5 Enter/Exit Fare + Subway Fare (\$2.50)</p> <p>\$5 Enter/Exit Fare + Train Fare (Peak hrs:\$9.50, off-peak hrs \$7.00 if purchased before boarding)</p>	<p>55 minutes</p> <p>40 minutes</p>	<p>Service available 24 hrs. Air Train:4-10 minutes</p> <p>Subway:4-12 minutes.</p> <p>LIRR: 2-22 minutes depending on the time of the day.</p>	<p>Connect to "E" subway train/LIRR at 'Jamaica Station'.</p> <p>Use pay-per-ride Metrocard is required to ride Air Train.</p>
<p><u>New York City Airporter Bus</u> (1-718) 777-5111</p> <p>(http://www.nycairporter.com/)</p>	<p>\$16</p>	<p>45 - 65 minutes (longer at peak hours)</p>	<p>Every 20-30 minutes 5:00 a.m. - 11:30 p.m.</p>	<p>The bus stops at Penn Station, Grand Central Terminal and the Port Authority Bus Terminal (PABT). Transfer at Bryant Park (42nd st btwn 5th & 6th ave) for complimentary shuttle van to all Midtown Manhattan Hotels located between 23rd and 63rd Streets.</p>
<p><u>SuperShuttle Manhattan</u></p> <p>Shared door to door minibus 1-800-258-3826 (www.supershuttle.com)</p>	<p>\$19</p>	<p>45 – 75 minutes (depending on traffic)</p>	<p>Available 24 hours.</p>	<p>No reservation is required for trip from Airport to Manhattan. Follow the signs to Ground Transportation Desk near the Baggage Claim area. Ask an agent to arrange for service or call Super Shuttle directly from the courtesy phone.</p> <p>24-48 hours reservations required for return service.</p>
<p><u>Taxi</u></p>	<p>Flat rate \$52 plus toll (\$5.33 each) and tips</p> <p>(10-15% is customary).</p>	<p>40 - 60 minutes (longer at peak hours).</p>	<p>Available 24 hours a day.</p>	<p>Follow the signs to Taxi Stands in front of terminals.</p>

From Newark Liberty International Airport

Service	Fare	Estimated Time of Arrival	Frequency	Notes
<p><u>AirTrain Newark</u></p> <p>(http://www.panynj.gov/airtrainnewark/what.index.html)</p> <p>1-800-AIR RIDE Connection with NJTransit (www.njtransit.com)</p> <p>1-800-772-2222 or (973) 762-5100</p>	<p>NJ Transit Fare (\$12.50)</p>	<p>40 minutes</p>	<p>Air Train: 8-12 minutes. Available 24 hours.</p> <p>NJ Transit: 7-30 minutes depending on the time of the day between 4:46 a.m. and 1:55 a.m. For exact times check www.njtransit.com or call 1-800-626-RIDE</p>	<p>Take Air Train to 'Newark Int'l Airport Station' and transfer to the NJ Transit Trains to New York Penn Station.</p>
<p><u>Olympia Airport Express</u></p> <p>1-877- 8-NEWARK</p> <p>1-877 863-9275</p> <p>(http://www.panynj.gov/aviation/egtsfram.htm)</p>	<p>\$28 round-trip or \$16 one-way. \$16 one-way transfers to hotels via Grand Central Station.</p>	<p>30 - 60 minutes (longer at peak hours)</p>	<p>Every 15-30 minutes 4:00 a.m. – 1:00 a.m.</p>	<p>Drop off service to Grand Central Terminal (120 E. 41st St, between Park and Lexington Ave.), Port Authority (E. 42nd St and 8th Ave) or Penn Station (W. 34th St and 8th Ave)</p>
<p><u>SuperShuttle Manhattan</u></p> <p>Shared door to door minibus 1-800-258-3826 www.supershuttle.com</p>	<p>\$19</p>	<p>30 – 60 minutes (longer at peak hours)</p>	<p>Available on demand 24 hours.</p>	<p>No reservation is required for trip from Airport to Manhattan. Follow the signs to Ground Transportation Desk near the Baggage Claim area. Ask an agent to arrange for service or call Super Shuttle directly from the courtesy phone.</p> <p>24-48 hours reservations required for return service.</p>
<p><u>Taxi</u></p>	<p>Flat rate ranging from \$50 to \$65 plus tolls (\$16.50 – \$20.50 round trip toll) and tips (10-15%).</p>	<p>40 minutes (longer at peak hours).</p>	<p>Available during flight hours.</p>	<p>Follow the signs to Taxi Stands outside arrival areas.</p>

From La Guardia Airport:

Service	Fare	Estimated Time of Arrival	Frequency	Notes
<p><u>New York City Airporter Bus</u> (1-718) 777-5111</p> <p>(http://www.nycairporter.com/)</p>	\$13	30 - 45 minutes, (longer at peak hours)	Every 20-30 minutes 5:00 a.m. - 11:30 p.m.	The bus stops at Penn Station, Grand Central Terminal and the Port Authority Bus Terminal (PABT) . Transfer at Bryant Park (42nd st btwn 5th & 6th ave) for complimentary shuttle van to all Midtown Manhattan Hotels located between 23 rd and 63 rd Streets.
<p><u>SuperShuttle Manhattan</u></p> <p>Shared door to door minibus 1-800-258-3826 (www.supershuttle.com)</p>	\$19	45 – 75 minutes (depending on traffic)	Available on demand 7:00 a.m. - 11:30 p.m.	No reservation is required for trip from Airport to Manhattan. Follow the signs to Ground Transportation Desk near the Baggage Claim area. Ask an agent to arrange for service or call Super Shuttle directly from the courtesy phone. 24-48 hours reservations required for return service.
<p><u>Taxi</u></p>	\$21 - \$30 plus tolls (\$4.00) and tips (10-15% is customary) plus night surcharge (\$0.50 from 8:00 pm to 6:00 am) or weekday surcharge (\$1 Mon to Fri from 4:00 pm to 8:00 p.m.) if applicable.	20 - 30 minutes (longer at peak hours).	Available during flight hours.	Follow the signs to Taxi Stands in front of terminals.

Local Transportation

Subway and buses (www.mta.nyc.ny.us) are a convenient way to get around Manhattan. **Metro Card** valid for subway and bus can be purchased at subway stations.

Single: trip fare is \$2.50.

7-Day Metro Card costs \$30.00 (unlimited ride for one week for one person)

Yellow Cab Taxis are readily available around Manhattan. Taxis are a safe alternative for late night travel when train and buses can be few and far between. It is advisable not to take taxis without meters (illegal taxi), as they could charge exorbitant fares. Taxis should accept credit cards. While taxis are relatively expensive for a single person, they are more affordable with 3 or more riders. The rates for taxis are as follows:

Initial fare.....	\$2.50
Each 1/5 mile (4 blocks).....	\$0.50
Each 1 minute idle.....	\$0.50
Night surcharge.....	\$0.50 (after 8:00 p.m. until 6:00 a.m.)
Peak hour weekday surcharge.....	\$1.00 (M-F, 4:00 p.m. until 8:00 p.m.)
New York State Tax Surcharge	\$0.50
Additional riders.....	FREE

Pay only what's on the meter, plus a 15-20 per cent gratuity. On all trips within New York City, any bridge and tunnel tolls to the destination shall be paid by the passenger, who shall be so informed before the start of the trip. On all trips within the City of New York, return tolls shall not be charged except for trips over the Cross Bay Veterans, Marine Parkway-Gil Hodges Memorial, and Verrazano Narrows Bridges. On trips beyond the City of New York, all necessary tolls to and from the destination shall be paid by the passenger. There are additional charges for crossings outside the metropolitan area and New Jersey. Passengers are required to pay one way.

Money

The majority of ATMs (Automated Teller Machines) networks in New York City are linked to a network that most likely includes your bank at home. Hence, you would be able to make a cash withdrawal if you have a cash card (ATM Card) that offers **Cirrus** (www.mastercard.com/atmlocator/index.jsp) or **Plus** (www.visa.com/atm), the 2 most popular networks. There are fees and daily limits associated with withdrawing money using the above networks. Please check with your bank at home for this information.

Travelers cheques are another good and safe alternative. Be sure to keep a record of their serial numbers, so you are ensured a refund in case they are lost or stolen. The 3 most popular travelers cheques providers are **American Express** (American Express branches

www.americanexpress.com), **Visa** (Citibank branches), **MasterCard** (Thomas Cook Currency Services).

Credit Cards are a convenient way to pay for transactions. **American Express, Visa and MasterCard** (among others) are accepted virtually everywhere in New York.

Postal Services

United Nations Post Office
UN Secretariat Building
New York, NY 10017
1st Avenue (between E. 45th and E. 46th St., entry via Visitors Entrance)

US Postal Offices

884 2nd Ave
New York, NY 10017
(1-800) 275-8777

5 Tudor City Pl
New York, NY 10017
(1-800) 275-8777

Confirmation of Return Flights

Please contact the airline directly to reconfirm your flight.

Time

For the time difference between New York and your country, please refer to http://www.worldtimeserver.com/convert_time_in_US-NY.aspx

Weather

To check for current weather condition in New York, please refer to www.weather.com/weather/local/10017?lsw=10017&lwsa=WeatherLocalUndeclared&from=whatwhere

2. Registration Form

REGISTRATION FORM	
NAME:	
TITLE:	
ORGANIZATION:	
ACCOMMODATION IN NEW YORK	
NAME OF HOTEL:	
CHECK IN DATE:	
CHECK OUT DATE:	
ADDRESS & CONTACT NUMBERS¹	

Please submit this Registration Form to a UNSD staff member when arriving for the first day of the meeting.

Comments and suggestions on how to improve the resource guide:

¹ If accommodation is other than Hotel